

## Ville d'Épinay-sous-Sénart

### ***RESTRUCTURATION ET RENFORCEMENT DE LA STRUCTURE PORTEUSE DE LA DALLE DU CENTRE COMMERCIAL PRINCIPAL (CCP) ET POUR L'AMÉNAGEMENT D'UN POLE DE SERVICES PUBLICS (PSP)***

#### **Plan Général des Travaux**



**Restructuration de la dalle**

# Plan masse de l'opération Cœur de ville

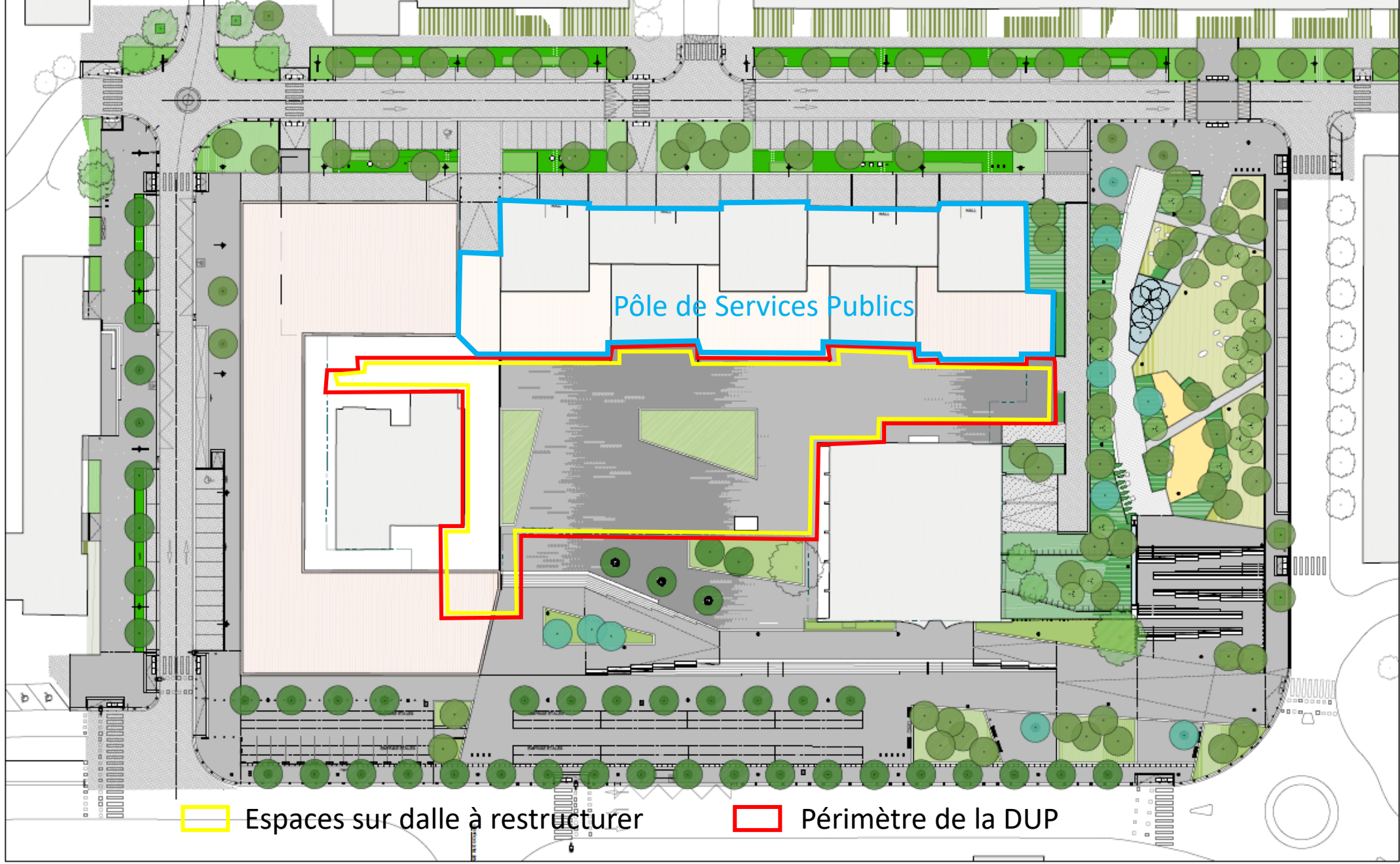

 Espaces sur dalle à restructurer

 Périmètre de la DUP



## CALEPINAGE

### Alternance

- dalle flammée 15/31cm  
60 % Granit grls type ATLANTIQUE  
40% Granit grls type LANHELIN





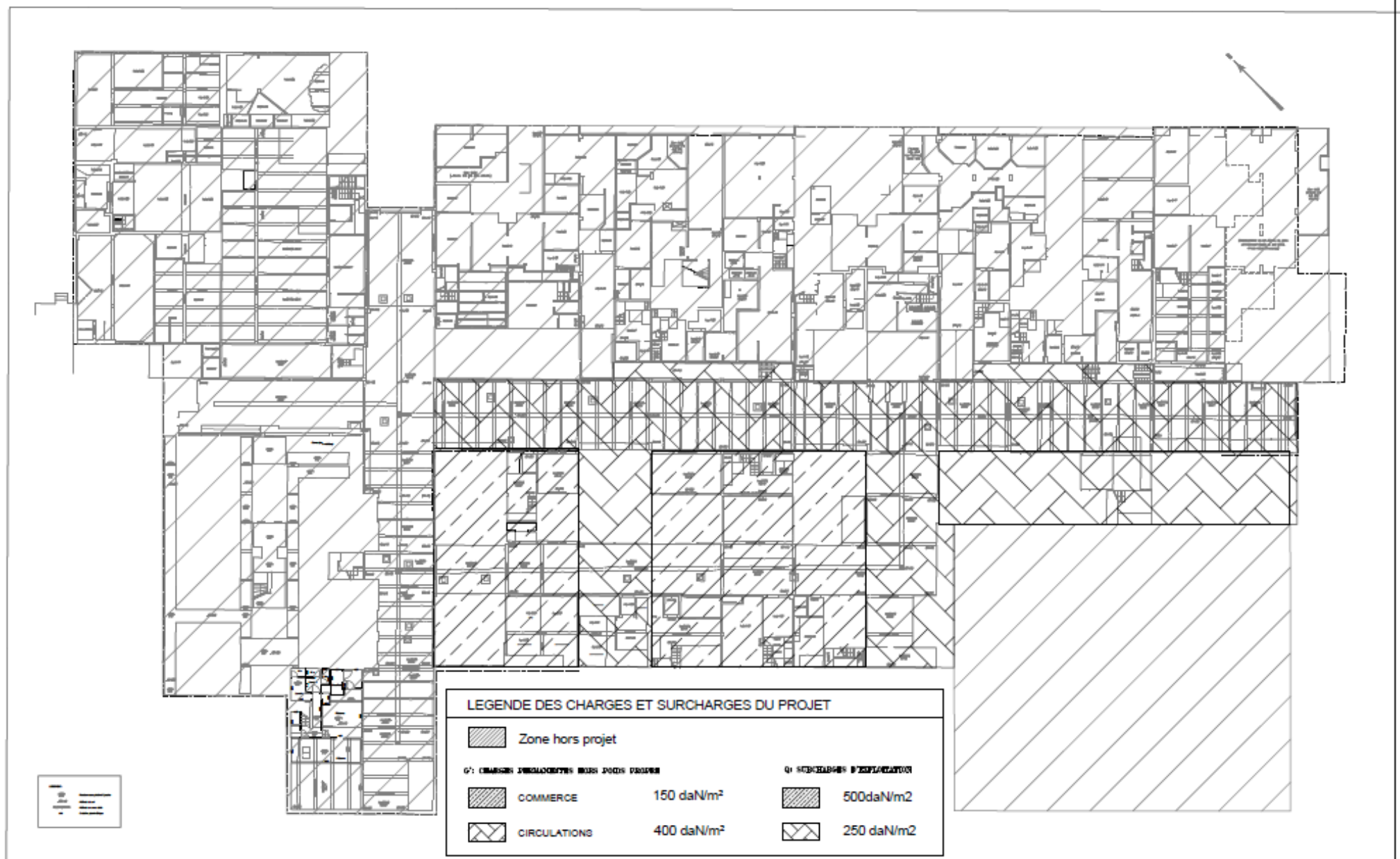

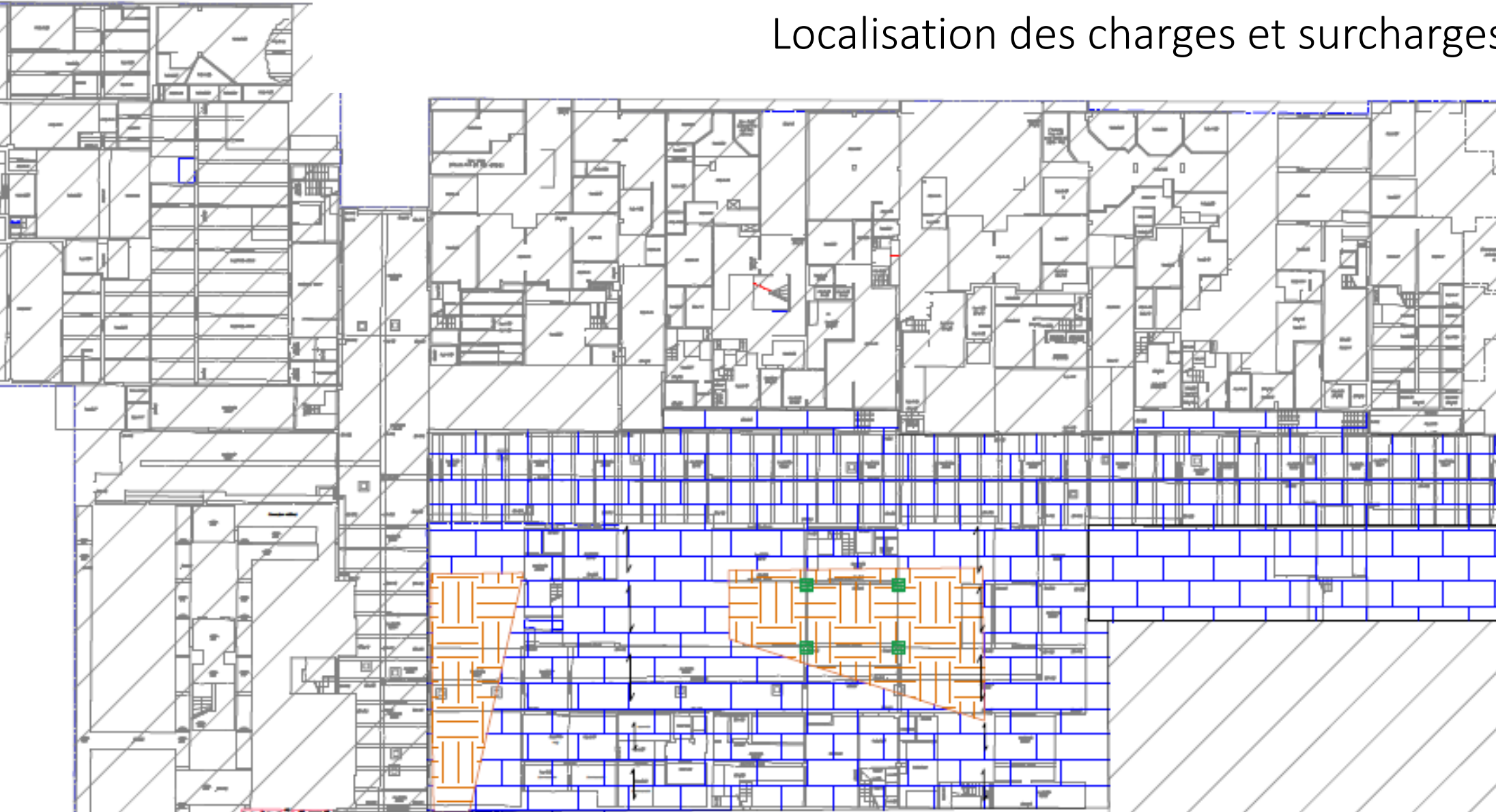

# Renforcement de la structure porteuse de la dalle



# Localisation des charges et surcharges







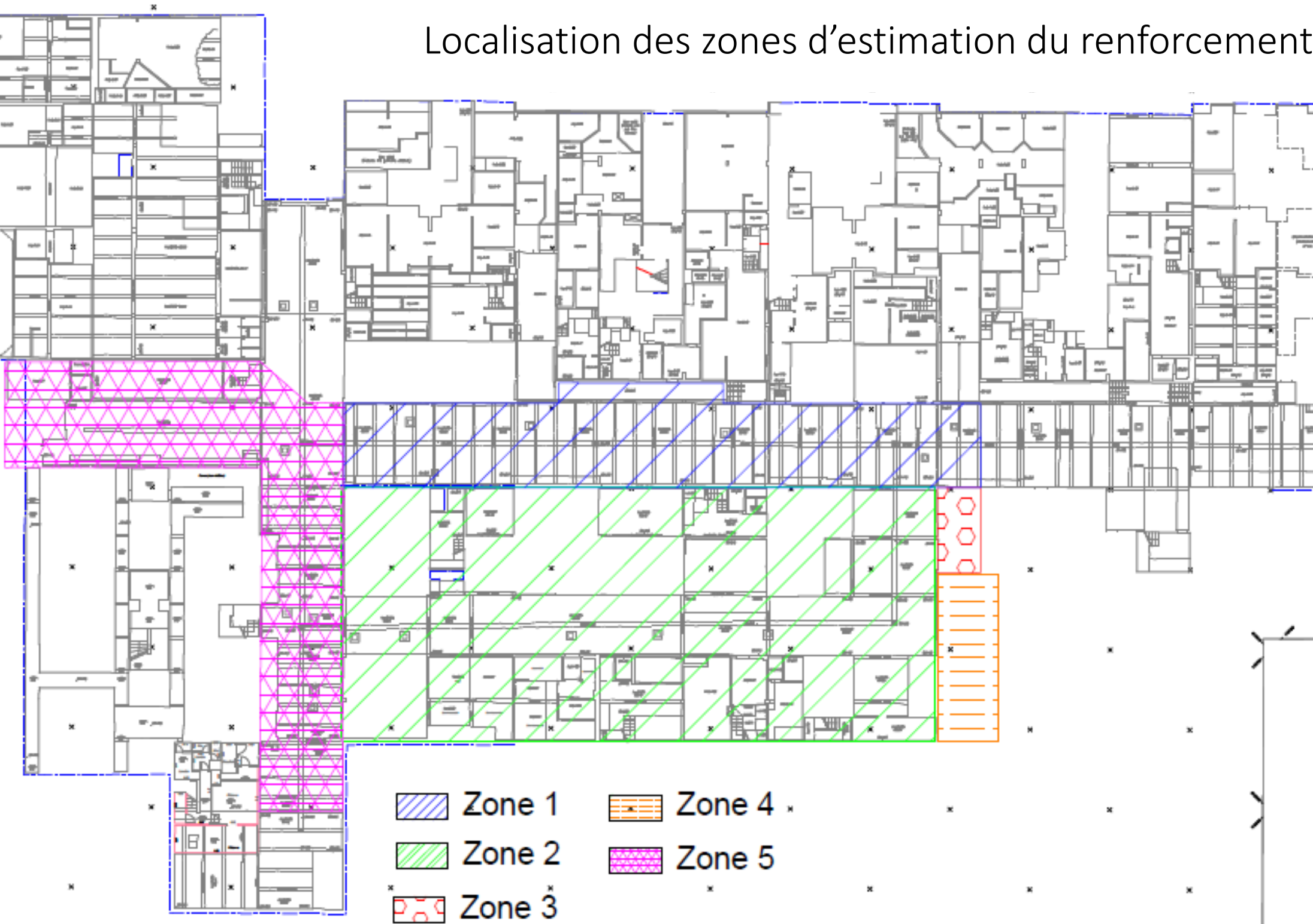

### LEGENDE DES CHARGES ET SURCHARGES DU PROJET

	Zone hors projet		
<b>Q1 CHARGES PERMANENTES ENNE POIDS PROPRE</b>		<b>Q2 SURCHARGES D'EXPLOITATION</b>	
	PARVIS DALLE GRANIT 450 daN/m <sup>2</sup>		500daN/m <sup>2</sup>
	PLATE-BANDE 40cm de ht 800 daN/m <sup>2</sup>		100 daN/m <sup>2</sup>
	PLATE-BANDE 100cm de ht 2000 daN/m <sup>2</sup>		100 daN/m <sup>2</sup>



# Localisation des zones d'estimation du renforcement

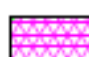

- |  |  |
|--|--|
|  Zone 1 |  Zone 4 |
|  Zone 2 |  Zone 5 |
|  Zone 3 |  |



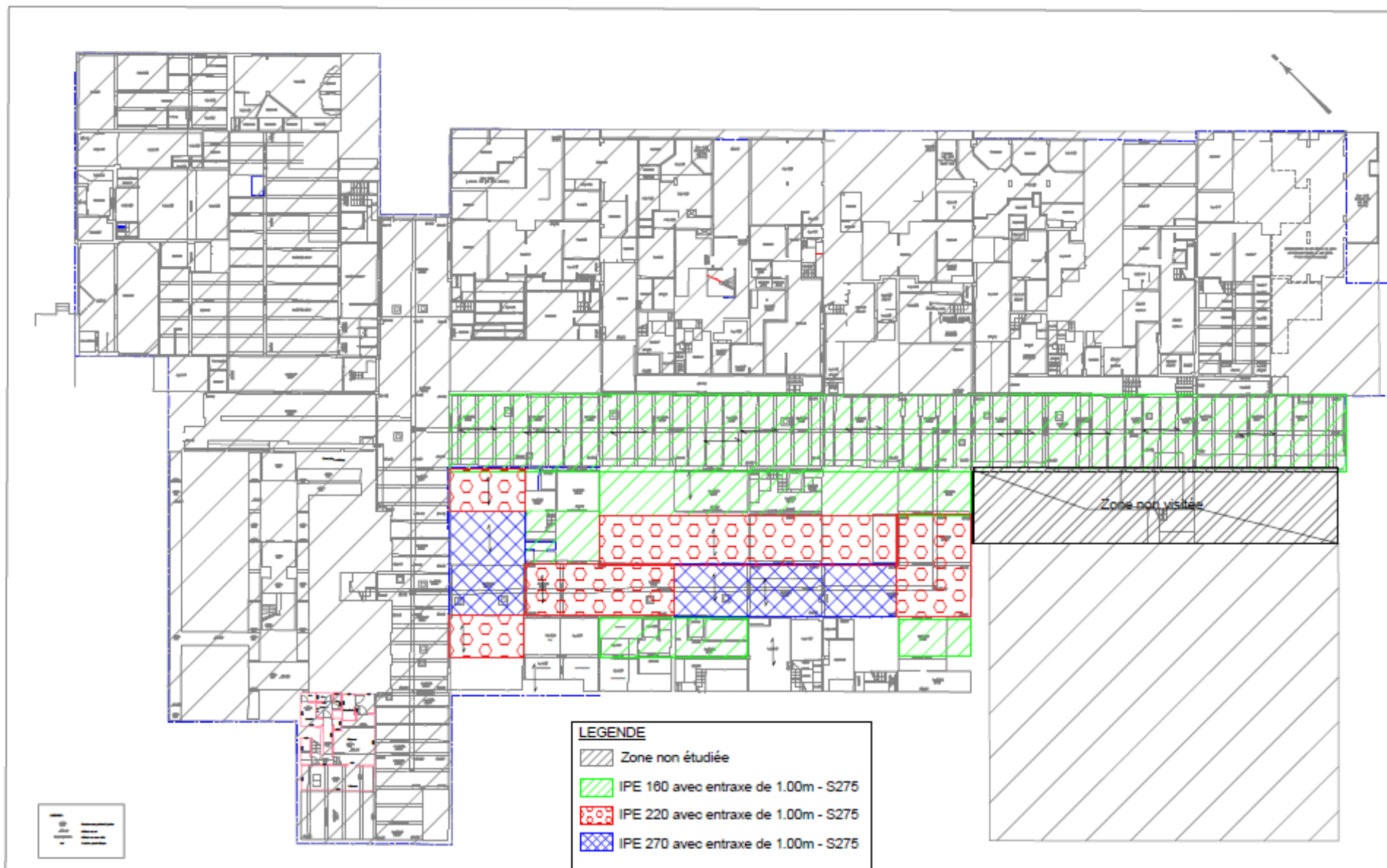

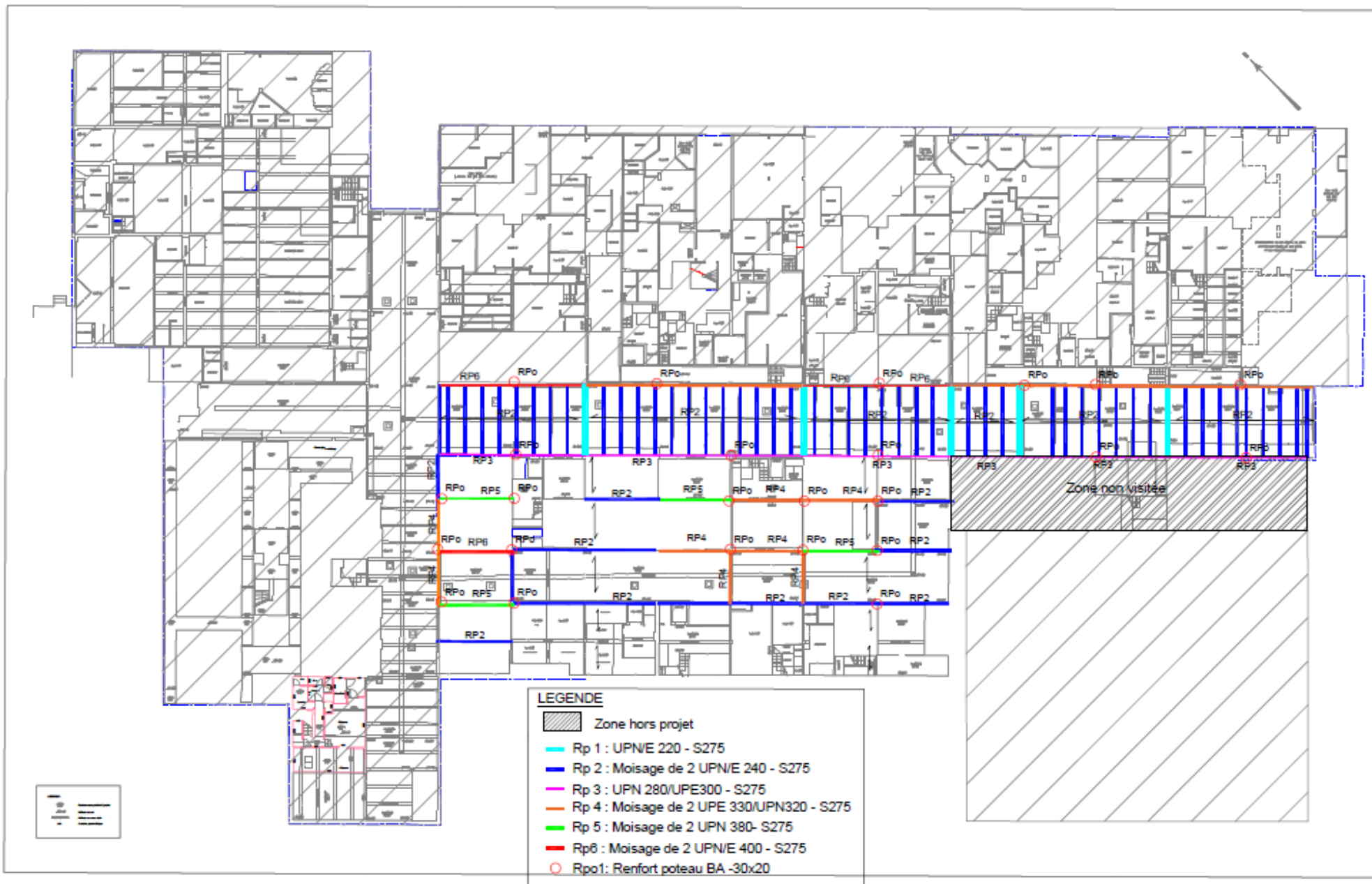

# Pôle de Services Publics

# Pôle de Services Publics – Niveau Supérieur

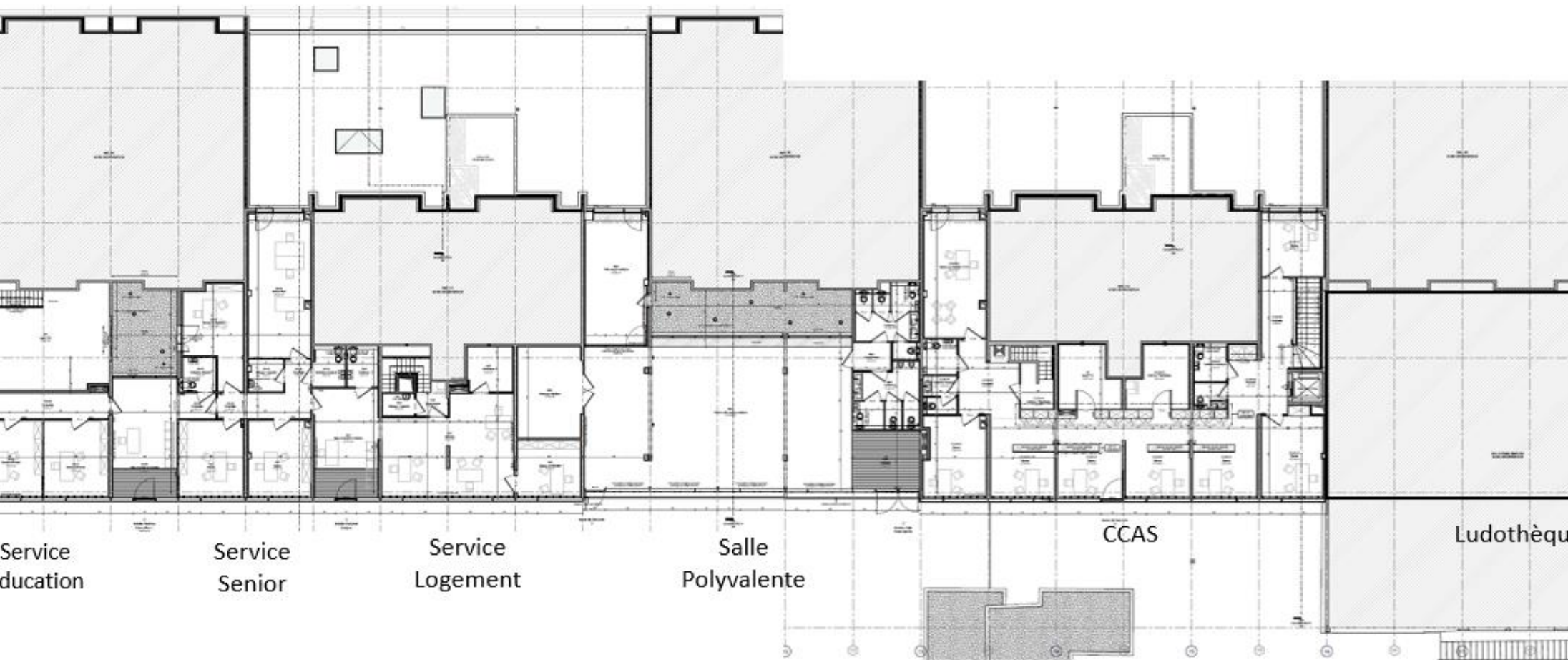

Coté Dalle



# Pôle de Services Publics – Niveau Inférieur

Rue Anatole France

Synagogue

Epicerie Sociale

Maison de l'emploi

CCAS

